



WASHING & DISINFECTION
hospital sector



For more than 30 years Smeg Instruments represents a symbol of **excellence "Made in Italy"**. It offers technologically advanced products to the **professional washing and thermal disinfection** world.

Fully customisable solutions, flexible and efficient services, safe and certifiable results thanks to an integrated structure from design to after-sales service.

Products enriched by know-how gained from working with professionals in more than thirty countries all over the world.



A GLOBAL BRAND

Smeg is an Italian family company based in Guastalla (RE), with 4 production plants in Italy, and has been manufacturing household appliances since 1948.

Smeg operates worldwide through subsidiaries, representative offices and an extensive network of distributors.

Vision, intuition, international scope: the Smeg Group, thanks to a corporate culture that places extreme attention to quality, technological content and attention to energy saving, is recognised internationally as one of the best Made in Italy companies.

EXCELLENCE MADE IN ITALY

Smeg certified laboratories interpret the needs of the industry in the best possible way, through their knowledge of materials and the latest technology. Regular and strict control tests throughout the entire production process testify to the brand's commitment to guaranteeing absolute reliability and improving environmental impact and energy consumption. Thanks to its long and consolidated experience in the in-house production of technologies for the treatment of medical instruments, Smeg is able to guarantee its customers perfect thermal disinfection quality. Washer disinfectors specially designed to cope with continuous thermal disinfection processes and the use of chemical disinfectants for the most critical situations.

CERTAINTY OF RESULTS

Quality

Smeg's Quality System complies with 93/42/EEC directive and s.m.i, ISO 9001:2015 and ISO 13485:2016 standards, as attested by the relevant certificates.

All washer-disinfectors, classified as class IIb medical devices, are CE certified and comply with EN 15883.

A0 parameter

Smeg washer-disinfectors offer a wide choice of programmes with pre-set or selectable A0 values depending on the type of instruments to be treated. The value of A0 displays in real time and/or is printed out.

Traceability

The Smeg washer-disinfector range offers all connection and data storage options for traceability in line with the international EN ISO 15883 standards.

Quality

Safety

Saving



THE DIFFERENT TYPES OF PRODUCTS AS WELL AS THE DIFFERENT SOLUTIONS ARE SPECIFICALLY DESIGNED TO MEET THE NEEDS OF OPERATORS IN THE VARIOUS FIELDS OF EQUIPMENT USE.

SIMPLE TO USE

Each function of the Smeg washer disinfector is controlled by user-friendly and highly intuitive display in order to facilitate the use of the equipment.



FLEXIBILITY

Smeg machines are designed to meet different washing requirements. These include surgical instruments, containers, minimally invasive instruments, endoscopy, optics, anesthesia sets and OP shoes. This is thanks to a wide range of inserts and accessories studied by the R & D department, along with specific washing programs which operate according to the material to be treated and to always obtain repeatable, safe and validated results.

VERY LOW NOISE

Smeg instrument washer disinfectors are designed to be as quiet as possible during each process. This ensures healthy working environments.



In the sterilisation and sub-sterilisation rooms, washing and thermal disinfection are today considered a fundamental step in the sterilization process.

The use of professional washer disinfectors is indispensable especially in the areas of treatment of surgical instruments, from minimally invasive to the processing of instruments used by the Da Vinci robot. The use of professional washer is also essential in the treatment of OP-shoes, in the lactarium, for washing and sanitizing bottles and teats, and infectious disease centres.

The Smeg washer disinfectors are versatile and flexible to suit all customer washing needs.



BABY BOTTLES

The new washer disinfectors models include specific programs for the treatment of baby bottles and teats used in neonatology departments to ensure complete elimination of possible sources of infection.



WASHER DISINFECTOR FOR INSTRUMENTS

The cleaning and thermal disinfection of operating room instrumentation (from stainless steel instruments for orthopedics and general surgery up to the most delicate sets for minimally invasive surgery, laparoscopy and orthopaedics), through the use of the Smeg washer disinfectors, is the necessary prerequisite for complete sterilization.



WASHER DISINFECTOR FOR OP SHOES

Thanks to special supports, Smeg's new generation washer disinfectors are a professional solution for the accurate and systematic treatment of heat-resistant op-shoes of medical and paramedical staff.



FREE-STANDING

Washer disinfectors can be installed freestanding.



Maximum number of CSKDIN basket inside the washing chamber.



WD2145 IS A WASHER DISINFECTOR WITH SLIM DIMENSIONS, DESIGNED WITH TWO WASHING LEVELS. THE WASHING CHAMBER MEASURES 370X480X620MM (105 LITRES) AND HAS THE CAPABILITY OF WASHING AND THERMAL DISINFECTION (UP TO 95°C).



D-ZCS1

WASHING SOLUTION FOR OP SHOES (D-ZCS1 TROLLEY FOR A MAXIMUM OF 3 PAIRS OF OP SHOES)



D-ZCS2

WASHING SOLUTION FOR OP SHOES (D-ZCS2 TROLLEY FOR A MAXIMUM OF 4 PAIRS OF OP SHOES)



CSK1/3

WASHING SOLUTION FOR SURGICAL INSTRUMENTS (CSK1/3 BASKET TO INSERT IN THE BASIC TROLLEYS D-CS1 AND D-CS2 WITH OTHER BASKETS AS FOR EXAMPLE D-CM1 AND D-SV)



CB18

BASKET WITH LID FOR 18X250 ML BABY BOTTLES



Other versions:
CB18/100: basket with lid for 18x100 ml baby bottles
CB18/120: basket with lid for 18x120 ml baby bottles



WD2145 TECHNICAL FEATURES	All versions
Electronic control	Microprocessor
Standard programs stored	15
Display with segments and communication led icons	Yes
Clock and calendar	Yes
Phase parameters	Type of water, detergent quantity, target temperature, extension time in minutes, temperature
Tank internal temperature	From room temperature to 95°C
Accuracy	0,1°C
Temperature sensors in tank	2 x PT 1000 CLASS B IEC 60751
Display	4 digits
Detergent and neutralizing agent dosing system	2 pumps as standard
Detergent level sensor	Yes
Safety lock	Yes, with electromagnetic release and automatic opening
Safety devices	Safety thermostats, door interlock
Alarm display	30
Troubleshooting menu	Yes, using PC connection
Program editing	Yes
AUXILIARY FUNCTIONS	
Traceability	Storage of data for 250 most recently run programs
RS232 serial port for PC connection	Yes
RS232 serial port for printer	Yes
Cycle storage	Yes
Cycle file download	Yes
WATER SUPPLY	
(PRESSURE 1,5-5 BAR)	
Cold water inlet	Yes, hardness max 42°F
Demineralized water inlet	Yes, < 20 µS/cm
Demineralized water booster pump	Optional
Water softener incorporated	Yes
Recirculation pump	200 l/min
WATER HEATING	
Electrical	3,0 kW Max
STEAM CONDENSER	Yes
DIMENSIONS LXDxH MM	
Outside (with built-in top)	450x620x850 (830)
Inside	370x480x620
Net weight (Kg)	56
STAINLESS STEEL	
Wash tank	AISI 316L
Exterior covering	AISI 304
ELECTRICAL POWER SUPPLY	
Max. voltage/power	1/N/PE 230V ~ 50Hz 3,3 kW
NOISE LEVEL	max 50 dB

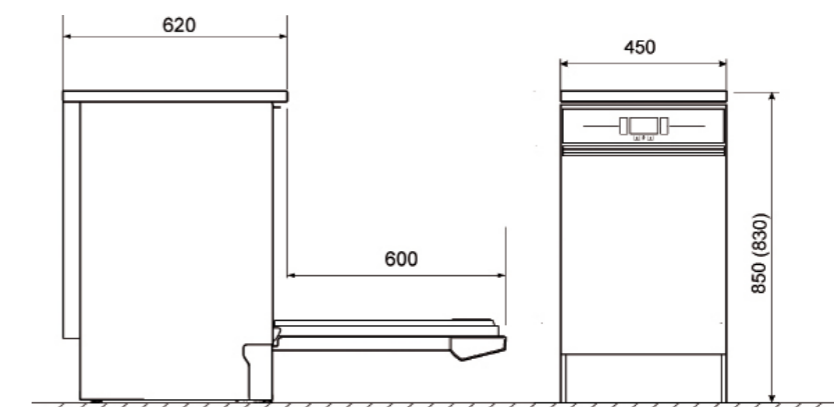

WD1160 IS A WASHER DISINFECTOR DESIGNED TO WORK WITH TWO TO FOUR WASHING LEVELS (UP TO 8 CSKDIN BASKET).

THE WASHING CHAMBER MEASURES 530X510X620MM (150 LITRES) AND HAS THE CAPABILITY OF WASHING AND THERMAL DISINFECTION (UP TO 95°C).



CE 0051

CPCENDO

WASHING SOLUTION OF CONTAINERS FOR ENDOSCOPES (CPCENDO TROLLEY)



CSK4B

WASHING SOLUTION FOR SURGICAL INSTRUMENTS (CSK4B TROLLEY WITH N. 4 CSKDIN BASKET MAX)



ZCS1

WASHING SOLUTION FOR OP SHOES (ZCS1 TROLLEY FOR A MAXIMUM OF 4 PAIRS OF OP SHOES)



ZCS2B

WASHING SOLUTION FOR OP SHOES (ZCS2 TROLLEY FOR A MAXIMUM OF 10 PAIRS OF OP SHOES)



CS3

WASHING SOLUTION FOR BABY BOTTLES WITH LIDS OF DIFFERENT DIMENSIONS AND PACIFIERS (TROLLEY CS3 WITH BASKET OF CB SERIE AND CPS20)



BFS

WASHING SOLUTION FOR GYNAECOLOGICAL INSTRUMENTS (ACCESSORY BFS TO INSERT IN THE BASIC TROLLEYS CS1-1 AND CS2)



D-SV

WASHING SOLUTION FOR ODONTOIATRIC INSTRUMENTS (BASKET D-SV TO INSERT IN THE BASIC TROLLEY CS1-1 AND CS2 WITH OTHER BASKETS AS FOR EXAMPLE D-CM1 AND CSMICRO2/3)



WD1160 TECHNICAL FEATURES		All versions
	Electronic control	Microprocessor
	Standard programs stored	15
Display with segments and communication led icons		Yes
	Clock and calendar	Yes
	Phase parameters	Type of water, detergent quantity, target temperature, extension time in minutes, temperature
	Tank internal temperature	From room temperature to 95°C
	Accuracy	0,1°C
	Temperature sensors in tank	2 x PT 1000 CLASS B IEC 60751
	Display	4 digits
Detergent and neutralizing agent dosing system		Max 3 pumps, 2 pumps as standard
	Detergent level sensor	Yes
	Safety lock	Yes, with electromagnetic release and automatic opening
	Safety devices	Safety thermostats, door interlock
	Alarm display	30
	Troubleshooting menu	Yes
	Program editing	Yes
AUXILIARY FUNCTIONS		
	Traceability	Yes
RS232 serial port for PC connection		Yes
RS232 serial port for printer		Yes
	Cycle storage	Yes
	Cycle file download	Yes
WATER SUPPLY (PRESSURE 1,5-5 BAR)		
	Cold water inlet	Yes, hardness max 42°F
	Demineralized water inlet	Yes, < 20 µS/cm
Demineralized water booster pump		Optional
	Water softener incorporated	Yes
	Recirculation pump	400 l/min
WATER HEATING		
	Electrical	6,3 kW on tri-phase version, 2,3 kW on single-phase version
STEAM CONDENSER		
		Yes
DIMENSIONS LXDxH MM		
	Outside (with built-in top)	600x600x850 (830)
	Inside	530x510x620
	Net weight (Kg)	74
STAINLESS STEEL		
	Wash tank	AISI 316L
	Exterior covering	AISI 304
ELECTRICAL POWER SUPPLY		
	Max. voltage/power	1/N/PE 230V ~ 50Hz 2,8 kW, 3/N/PE 400V - 50 Hz 7,0 kW
NOISE LEVEL		
		max 50 dB

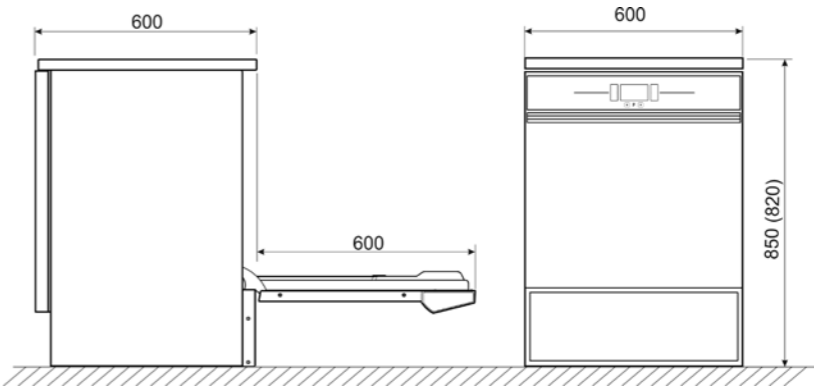

WD4060 IS A WASHER DISINFECTOR DESIGNED TO WORK WITH TWO TO FOUR WASHING LEVELS (UP TO 8 CSKDIN BASKET). THE WASHING CHAMBER MEASURES 530X510X620 MM (150 LITRES) AND HAS THE CAPABILITY OF WASHING, CHEMICAL DISINFECTION, THERMAL DISINFECTION (UP TO 95°C) AND ACTIVE DRYING WITH HEPA FILTER.



CE 0051

EF5DS

WASHING SOLUTION FOR RIGID VIDEOLAPAROSCOPE AND ENDOSCOPE (EF5DS TROLLEY)



CSK6B

WASHING SOLUTION FOR SURGICAL INSTRUMENTS (CSK6B TROLLEY WITH N. 6 CSKDIN BASKET MAX)



ZCS3B

WASHING SOLUTION FOR OP SHOES (ZCS3B TROLLEY FOR A MAXIMUM OF 14 PAIRS OF OP SHOES)





CE 0051

WD4060 TECHNICAL FEATURES		All versions
Electronic control	Microprocessor	
Standard programs stored	15	
Display with segments and communication led icons	Yes	
Clock and calendar	Yes	
Phase parameters	Type of water, detergent quantity, target temperature, extension time in minutes, temperature	
Tank internal temperature	From room temperature to 95°C	
Accuracy	0,1°C	
Temperature sensors in tank	2 x PT 1000 CLASS B IEC 60751	
Display	4 digits	
Detergent and neutralizing agent dosing system	Max 3 pumps, 2 pumps as standard	
Detergent level sensor	Yes	
Safety lock	Yes, with electromagnetic release and automatic opening	
Safety devices	Safety thermostats, door interlock	
Alarm display	30	
Troubleshooting menu	Yes	
Program editing	Yes	
AUXILIARY FUNCTIONS		
Traceability	Yes	
RS232 serial port for PC connection	Yes	
RS232 serial port for printer	Yes	
Cycle storage	Yes	
Cycle file download	Yes	
DRYING SYSTEM		
Drying fan	Yes	
Drying heating element	0,8 kW	
Prefilter class C 98%	Yes	
HEPA filter Class S 99.999%	Yes	
WATER SUPPLY (PRESSURE 1,5-5 BAR)		
Cold water inlet	Yes, hardness max 42°F	
Demineralized water inlet	Yes	
Demineralized water booster pump	Optional	
Water softener incorporated	Yes	
Recirculation pump	400 l/min	
WATER HEATING		
Electrical	6,3 kW on tri-phase version, 2,3 kW on single-phase version	
STEAM CONDENSER		
	Yes	
DIMENSIONS LXDxH MM		
Outside (with built-in top)	600x600x850 (830)	
Inside	530x510x620	
Net weight (Kg)	77	
STAINLESS STEEL		
Wash tank	AISI 316L	
Exterior covering	AISI 304	
ELECTRICAL POWER SUPPLY		
Max. voltage/power	1/N/PE 230V ~ 50Hz 2,8 kW 3/N/PE 400V - 50 Hz 7,0 kW	
NOISE LEVEL		
	max 50 dB	

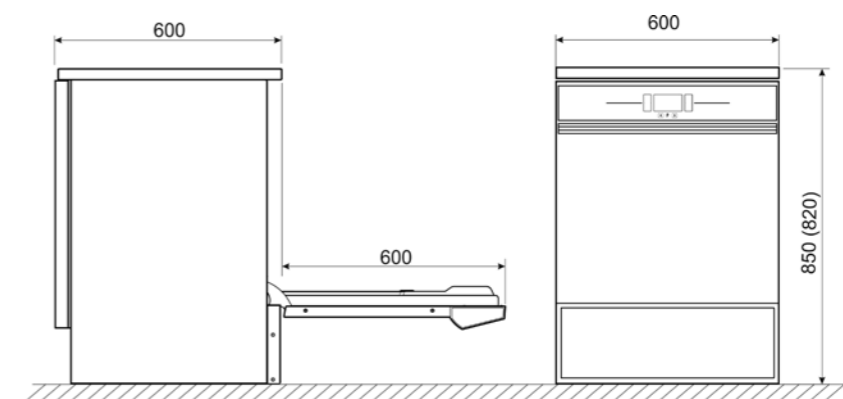



BASIC LINE

WD4190 IS A WASHER DISINFECTOR DESIGNED TO WORK WITH TWO TO FOUR WASHING LEVELS (UP TO 8 CSKDIN BASKET). A DETERGENT CABINET IS INCORPORATED. THE WASHING CHAMBER MEASURES 530X510X620 MM (150 LITRES) AND HAS THE CAPABILITY OF WASHING, CHEMICAL DISINFECTION, THERMAL DISINFECTION (UP TO 95°C) AND ACTIVE DRYING WITH HEPA FILTER.



CSK8B

WASHING SOLUTION FOR SURGICAL INSTRUMENTS (CSK8B TROLLEY WITH N. 8 CSKDIN BASKET MAX)



AE2BDS

WASHING SOLUTION FOR ANESTHESIA INSTRUMENTS (AE2BDS TROLLEY)





WD4190 TECHNICAL FEATURES		All versions
Electronic control	Yes	
Standard programs stored	15	
Display with segments and communication led icons	Yes	
Clock and calendar	Yes	
Phase parameters	Type of water, detergent quantity, target temperature, extension time in minutes, temperature	
Tank internal temperature	From room temperature to 95°C	
Accuracy	0,1°C	
Temperature sensors in tank	2 x PT 1000 CLASS B IEC 60751	
Display	4 digits	
Detergent and neutralizing agent dosing system	Max 3 pumps, 2 pumps as standard	
Detergent level sensor	Yes	
Safety lock	Yes, with electromagnetic release and automatic opening	
Safety devices	Safety thermostats, door interlock	
Alarm display	30	
Troubleshooting menu	Yes	
Program editing	Yes	
Built-in Detergent Cabinet	Yes	
AUXILIARY FUNCTIONS		
Traceability	Yes	
RS232 serial port for PC connection	Yes	
RS232 serial port for printer	Yes	
Panel printer	Yes, optional	
Cycle storage	Yes	
Cycle file download	Yes	
DRYING SYSTEM		
Drying fan	Yes	
Drying heating element	0,8 kW	
Prefilter class C 98%	Yes	
HEPA filter Class S 99.999%	Yes	
WATER SUPPLY (PRESSURE 1,5-5 BAR)		
Cold water inlet	Yes, hardness max 42°F	
Demineralized water inlet	Yes	
Demineralized water booster pump	Optional	
Water softener incorporated	Yes	
Recirculation pump	400 l/min	
WATER HEATING		
Electrical	6,3 kW on tri-phase version, 2,3 kW on single-phase version	
STEAM CONDENSER		Yes
DIMENSIONS LXXH MM		
Outside (with built-in top)	900x600x850 (830)	
Inside	530x510x620	
Net weight (Kg)	83	
STAINLESS STEEL		
Wash tank	AISI 316L	
Exterior covering	AISI 304	
ELECTRICAL POWER SUPPLY		
Max. voltage/power	1/N/PE 230V ~ 50Hz 2,8 kW 3/N/PE 400V ~ 50Hz 7,0 kW	
NOISE LEVEL		max 50 dB

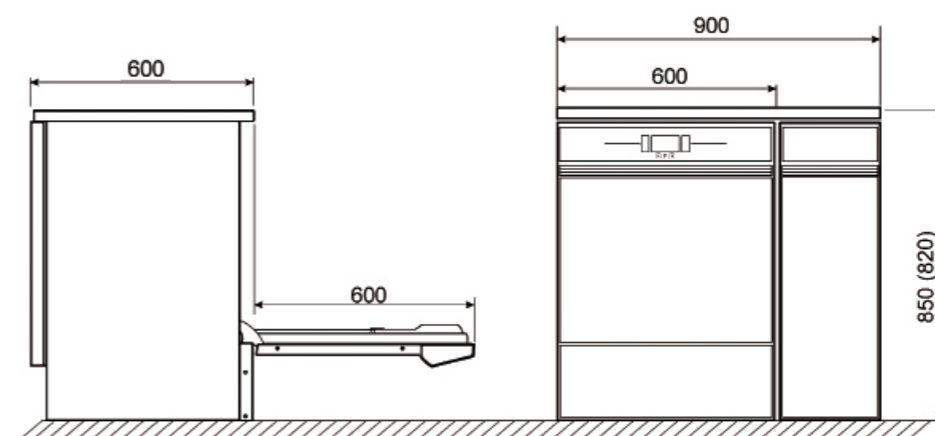

WD5090T IS A WASHER DISINFECTOR DESIGNED TO WORK WITH TWO TO FOUR WASHING LEVELS (UP TO 8 CSKDIN BASKET). THE MACHINE HAS A PROFESSIONAL ELECTRONIC CONTROL WITH LCD GRAPHIC DISPLAY, WHICH CONTROLS THE WASHING QUANTITY AND ALLOWS CONNECTION TO THE LOCAL NETWORK. A DETERGENT CABINET IS INCORPORATED. THE WASHING CHAMBER MEASURES 530X510X620 MM (150 LITRES), THE POSSIBILITY OF WASHING, CHEMICAL DISINFECTION, THERMAL DISINFECTION (UP TO 95°C) AND ACTIVE DRYING WITH HEPA FILTER.



CSK6B

WASHING SOLUTION FOR SURGICAL INSTRUMENTS (CSK6B TROLLEY WITH N. 6 CSKDIN BASKET MAX)



EF5DS

WASHING SOLUTION FOR RIGID VIDEOLAPAROSCOPE AND ENDOSCOPE (EF5DS TROLLEY)



CSK4BMIC

WASHING SOLUTION FOR SURGICAL INSTRUMENTS AND MINIMALLY INVASIVE SURGERY ACCESSORIES (CSK4BMIC TROLLEY WITH 1 KITMIC BASKET TO PUT INSIDE MINIMALLY INVASIVE SURGERY ACCESSORIES AND N. 3 CSKDIN BASKETS FOR SURGICAL INSTRUMENTS).



AE2BDS

WASHING SOLUTION FOR ANESTHESIA
INSTRUMENTS (AE2BDS TROLLEY)



CPC1B

WASHING SOLUTION FOR MAX 2 CONTAINERS
TROLLEY FOR WASHING UP TO 2 CONTAINERS
WITH THEIR LIDS. DIMENSIONS PER CONTAINER
(LXWXH) 300X300X150 MM.



CM3

WASHING SOLUTION FOR MASKS (CM3 TROLLEY)



WD5090 TECHNICAL FEATURES	All versions
Electronic control	Yes
Standard programs stored	30 (expandable to 50)
Display with segments and communication led icons	Yes
Clock and calendar	Yes
Phase parameters	Type of water, detergent quantity, target temperature, extension time in minutes u.d. pag. 37
Tank internal temperature	From room temperature to 95°C
Accuracy	0,1°C
Temperature sensors in tank	2 x PT 1000 CLASS B IEC 60751
Backlit graphic LCD display	128x64 pixels
Detergent and neutralizing agent dosing system	Max 4 pumps, 2 pumps as standard
Detergent level sensor	Yes
Safety lock	Yes, with electromagnetic release and automatic opening
Safety devices	Safety thermostats, door interlock
Alarm display	80
Troubleshooting menu	Yes
Program editing	Yes
Display languages	Italian, English, French, German, Russian, Spanish, Turkish and others on request
Built-in Detergent Cabinet	Yes
AUXILIARY FUNCTIONS	
External sensor duct	Optional
Waste water separation solenoid valve control	Optional
Traceability	Yes
RS232 serial port for PC connection	Yes
RS232 serial port for printer	Yes
Panel printer	Yes, optional
Cycle storage	Yes
Cycle file download	Yes
DRYING SYSTEM	
Drying fan	Yes
Drying heating element	2,5 Kw
Prefilter class C 98%	Yes
HEPA filter Class S 99.999%	Yes
ALIMENTAZIONE IDRICA (PRESSIONE 1,5-5 bar)	
Cold water inlet	Yes, hardness max 42°F
Demineralized water inlet	Yes
Demineralized water booster pump	Optional
Water softener incorporated	Yes
Recirculation pump	400 l/min
WATER HEATING	
Electrical	6,3 kW
Water pre-heating via boiler	Optional
STEAM CONDENSER	Yes
DIMENSIONS LXXH MM	
Outside (with built-in top)	900x640x850 (830)
Inside	530x510x620
Net weight (Kg)	83
STAINLESS STEEL	
Wash tank	AISI 316L
Exterior covering	AISI 304
ELECTRICAL POWER SUPPLY	
Max. voltage/power	3/N/PE 400V ~ 50Hz 7,0 kW
NOISE LEVEL	max 50 dB

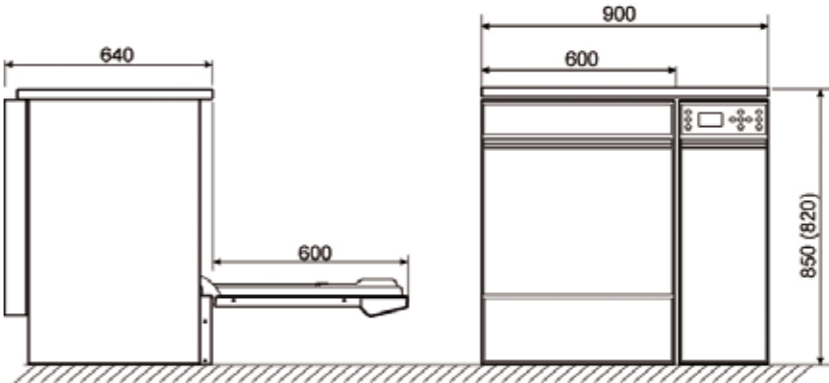

WD6010 IS A SINGLE OR DOUBLE GLASS DROP DOWN DOOR WASHER-DISINFECTOR. WASHING CAPACITY OF UP TO 12 DIN BASKETS WITH 65-CM WIDTH. THE DROP DOWN DOOR ALLOWS THE OPERATOR TO ERGONOMICALLY LOAD AND UNLOAD THE BASKETS INCLUDED IN THE TROLLEY WITHOUT HAVING TO LIFT HEAVY WEIGHTS.

ALSO AVAILABLE IN A VERSION WITH TURBO CYCLES (WD6010T MODEL).



CSK1010

CSK1010: 5-LEVEL TROLLEY WITH CAPACITY FOR UP TO 10 DIN BASKETS. EQUIPPED WITH A BUILT-IN SPRAY ARM ON EACH LEVEL.



INSPMIC10

INSPMIC10: INSERT FOR MINIMALLY INVASIVE SURGERY INSTRUMENTS TO BE USED IN COMBINATION WITH THE CSK1010FLEX TROLLEY. SUITABLE FOR WASHING CANNULATED SURGICAL INSTRUMENTS AND HOLLOW INSTRUMENTS.



SCDIN10

SCDIN10: SUPPORT FOR WASHING DIN CONTAINERS. TO BE USED IN COMBINATION WITH TROLLEY TYPE CSK1210UNIV OR CSK1210FLEX.





CE 0051

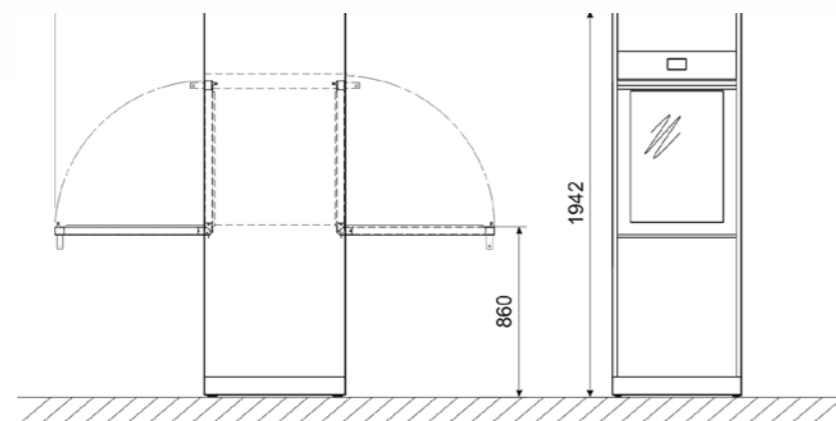

WD6010 TECHNICAL FEATURES		All versions
Glass doors: n and type	2 - flap (single door and/or steel door models available)	
Electronic control	Yes	
Standard programs stored	20	
Freely editable custom programs	Yes	
Phase parameters	Water type, detergent quantity, target temperature, time extension	
Tank internal temperature	From room-temperature to 95°C	
Accuracy	0,1°C	
Temperature sensors in tank	2 x PT 1000 CLASS B IEC 60751	
Display	Multilingual graphic touch screen, color TFT type	
Detergent and neutralizing agent dosing system	Max. 4 peristaltic pumps, of which 2 as standard	
Detergent level sensor	Yes	
Detergent dosage control	Yes	
Safety lock	Yes, with security unlocking system	
Safety devices	Safety thermostats, door locks, interlocked doors, emergency door release, switch general safety power supply	
Alarm display	>100	
Troubleshooting menu	Yes	
Program editing	Yes	
Display languages	Italian, English, French, German, Russian, Spanish, Portuguese, Polish	
AUXILIARY FUNCTIONS		
Duct for introducing external probes	Yes	
Control system for drain separation solenoid valves	Yes	
USB port	Yes, for downloading wash cycles on a flash drive	
LAN port	Optional	
Printer	Integrated (Optional)	
Cycles archiving	Yes	
Download archive cycles	Yes	
DRYING SYSTEM	Yes	
Drying fan	Yes	
Drying heating element	3,6 kW	
Prefilter class C 98%	Yes	
HEPA filter Class S 99.999%	Yes	
WATER SUPPLY (PRESSURE 1,5-5 BAR)		
Cold water inlet	Yes	
Demineralized water inlet	Yes	
Demineralized water booster pump	Yes	
Water softener incorporated	Optional	
Incorporated softener	No	
Recirculation pump	600 l/min	
Drain	Floor drainage (possibility of wall drainage with optional pump)	
WATER HEATING		
Electrical	12kW	
Boiler for water preheating	Optional, specific model available	
STEAM CONDENSER	Yes, optional	
DIMENSIONS LXXDXXH MM		
Outside (with built-in top)	650 x 720 x 1950	
Inside	550 x 620 x 685	
Net weight (Kg)	280	
STAINLESS STEEL		
Wash tank	AISI 316L	
Exterior covering	AISI 304	
ELECTRICAL POWER SUPPLY		
Max. voltage/power	400V 3N~ / 50Hz / 13 kW	
NOISE LEVEL	Max 66 dBA	

WASHER DISINFECTOR WD7010



PROFESSIONAL LINE

WD7010 IS A SINGLE OR DOUBLE GLASS DOOR WASHER-DISINFECTOR WITH AUTOMATIC DOWNWARD SLIDING OPENING/CLOSING. WASHING CAPACITY OF UP TO 12 DIN BASKETS WITH 78-CM WIDTH. LATEST FULL TOUCH ELECTRONIC CONTROL. RELIABLE RESULTS GUARANTEED.
ALSO AVAILABLE IN THE VERSION WITH TURBO CYCLES (WD7010T MODEL).



CE 0051

CSK10

5-LEVEL TROLLEY FOR FLEXIBLE WASHING OF BOTH DIN BASKETS AND CONTAINERS



CSK1010FLEX

5-LEVEL TROLLEY WITH CAPACITY FOR UP TO 10 DIN BASKETS, WITH SHELVES 2, 4 AND 5 THAT CAN BE PULLED OUT



SZ1010

WASHING SOLUTION FOR OP SHOES. TROLLEY CSK1210FLEX/CSK1210UNIV (MAX 2 PAIRS- TOT 20 PAIRS) OR CSK1010FLEX (MAX 1- TOT 10 PAIRS)



INSPMIC10

INSPMIC10: INSERT FOR MINIMALLY INVASIVE SURGERY INSTRUMENTS TO BE USED IN COMBINATION WITH THE CSK1010FLEX TROLLEY. SUITABLE FOR WASHING CANNULATED SURGICAL INSTRUMENTS AND HOLLOW INSTRUMENTS.

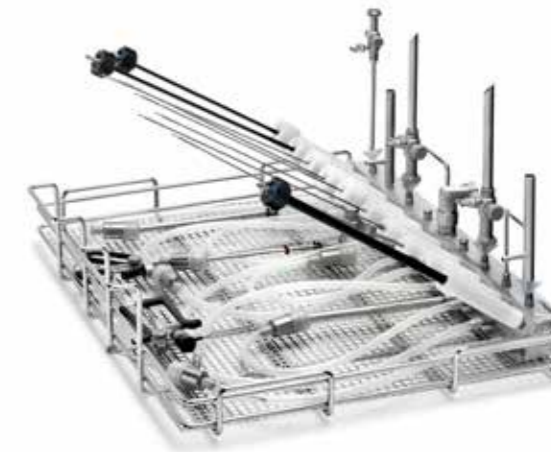



CE 0051

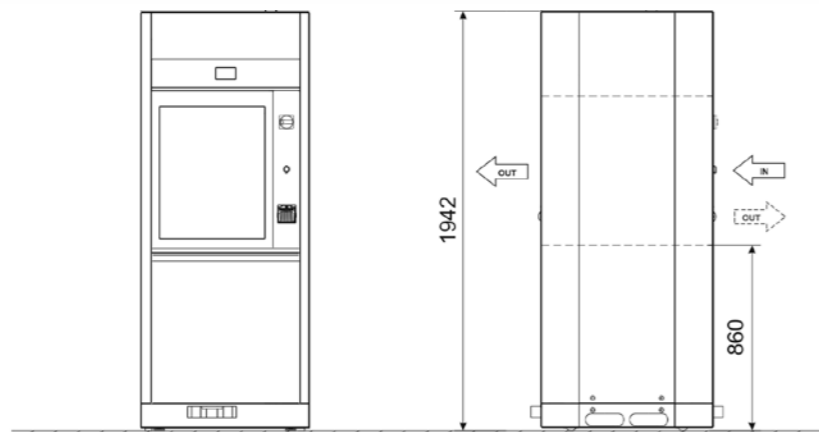

WD7010 TECHNICAL FEATURES		All versions
Glass doors: n and type	2 - sliding	
Electronic control	Yes	
Standard programs stored	20	
Freely editable custom programs	Yes	
Phase parameters	Water type, detergent quantity, target temperature, time extension	
Tank internal temperature	from room-temperature to 95°C	
Accuracy	0,1°C	
Temperature sensors in tank	2 x PT 1000 CLASS B IEC 60751	
Display	Multilingual graphic touch screen, color TFT type	
Detergent and neutralizing agent dosing system	Max. 4 peristaltic pumps, of which 2 as standard	
Detergent level sensor	Yes	
Detergent dosage control	Yes	
Safety lock	Yes, with security unlocking system	
Safety devices	Safety thermostats, door locks, interlocked doors, emergency door release, switch general safety power supply	
Alarm display	>100	
Troubleshooting menu	Yes	
Program editing	Yes	
Display languages	Italian, English, French, German, Russian, Spanish, Portuguese, Polish	
AUXILIARY FUNCTIONS		
Duct for introducing external probes	Yes	
Control system for drain separation solenoid valves	Yes, solenoid valves as optional	
USB port	Yes, for downloading wash cycles on a flash drive	
LAN port	Optional	
Printer	Integrated (optional)	
Cycles archiving	Yes	
Download archive cycles	Yes	
DRYING SYSTEM		
Drying fan	Yes	
Drying heating element	3,6 kW	
Prefilter class C 98%	Yes	
HEPA filter Class S 99.999%	Yes	
WATER SUPPLY (PRESSURE 1-6 BAR)		
Cold water inlet	Yes	
Demineralized water inlet	Yes	
Demineralized water booster pump	Yes	
Water softener incorporated	Optional	
Incorporated softener	No	
Recirculation pump	600 l/min	
Drain	Floor drainage (possibility of wall drainage with optional pump)	
WATER HEATING		
Electrical	12kW	
Boiler for water preheating	Optional, specific model available	
STEAM CONDENSER		Yes, optional
DIMENSIONS L X D X H MM		
Outside (with built-in top)	780 x 800 x 1950	
Inside	550 x 620 x 685	
Net weight (Kg)	300	
STAINLESS STEEL		
Wash tank	AISI 316L	
Exterior covering	AISI 304	
ELECTRICAL POWER SUPPLY		
Max. voltage/power	400V 3N~ / 50Hz / 13 kW	
NOISE LEVEL		Max 66 dBA

WASHER DISINFECTOR WD7015



PROFESSIONAL LINE

WD7015 IS A SINGLE OR DOUBLE GLASS DOOR WASHER-DISINFECTOR WITH AUTOMATIC DOWNWARD SLIDING OPENING/CLOSING. WASHING CAPACITY OF UP TO 18 DIN BASKETS WITH 90-CM WIDTH. LATEST FULL TOUCH ELECTRONIC CONTROL. RELIABLE RESULTS GUARANTEED.
ALSO AVAILABLE IN THE VERSION WITH TURBO CYCLES (WD7015T MODEL).



CSK1815FLEX

6 WASHING LEVEL FLEXIBLE TROLLEY



6-level flexible trolley with capacity for up to 18 DIN baskets. The intermediate levels are equipped with a built-in spray arm, while the upper and lower levels are washed by sprayers on the top and bottom of the tank. Removable washing racks for handling instruments/objects with different heights.

CSKDAVSI1215

ROBOT FOR WASHING INSTRUMENTATION USED BY DA VINCI SURGICAL SYSTEM I



Instrument washing trolley series Si 5-8 mm used by Da Vinci Surgical System. Also equipped with 2 connections for the connection of control probes (one for each collector branch), interlocking system, 2 micro-filters (one for each collector branch) and the possibility of housing up to 3 x CSKDIN (not included) on the bottom plate. Also available in other configurations.

CPCDIN415

INJECTION MOULDED TROLLEY FOR WASHING 4 CONTAINERS + 4 LIDS (MAX. CONTAINER DIMENSIONS LXVXH: 600X300X270 MM).



CSKAE1015

ANAESTHESIA SET WASHING TROLLEY EQUIPPED WITH INJECTION SUPPORTS FOR CORRUGATED TUBES, MAX. LENGTH 1500 MM, NOZZLES FOR ET TUBES, MASKS AND ACCESSORIES AND NOZZLES FOR FLASKS.

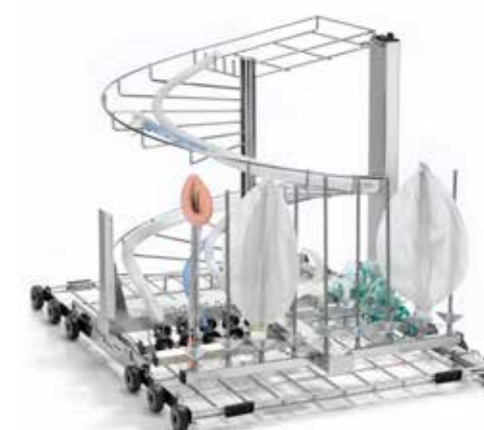

CB7015

THE SMEG CB7015 CONVEYOR BELT IS A SYSTEM FOR THE AUTOMATIC LOADING AND UNLOADING OF WASHING TROLLEYS TO BE INTEGRATED ON MACHINES EQUIPPED WITH DOUBLE DOORS, AUTOMATIC AND SLIDING DOORS. ENABLES GREATER PROCESS AUTOMATION, ENSURING MAXIMUM EFFICIENCY AND PRODUCTIVITY



CB7015L1 e CB7015U1



CB7015L1T



CB7015L2 e CB7015U2



CB7015L2T



CB7015L3 e CB7015U3



CB7015L3T

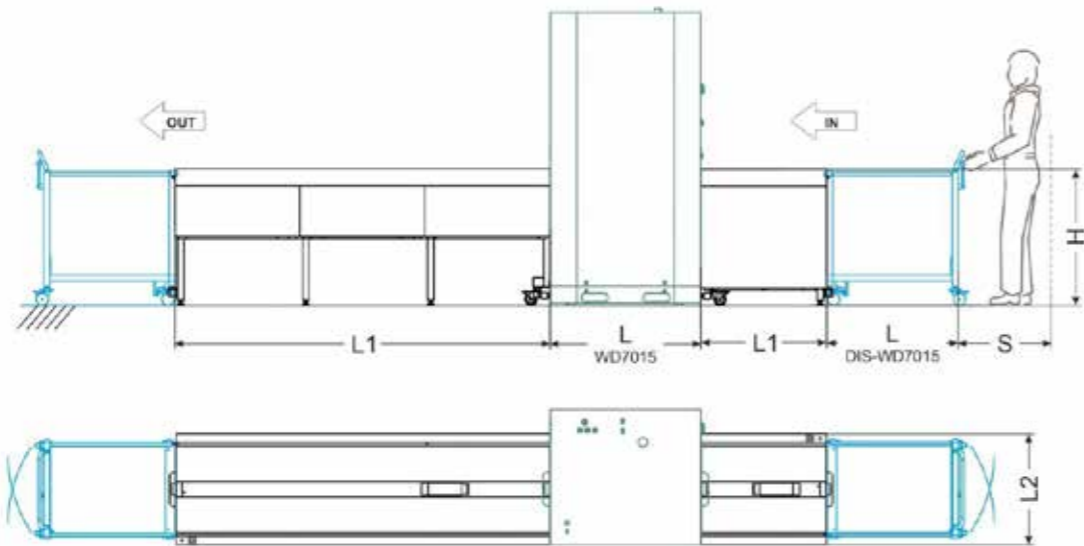

	L1 - HEIGHT (mm)	L2 - WIDTH (mm)	H - DEPTH (mm)
CB7015L1	833	738	890
CB7015L2	1666	738	890
CB7015L3	2497	738	890
CB7015L1T	833	738	890
CB7015L2T	1666	738	890
CB7015L3T	2497	738	890
CB7015U1	833	738	890
CB7015U2	1666	738	890
CB7015U3	2497	738	890

WD7015 TECHNICAL FEATURES		All versions
Glass doors: n and type	2 - sliding	
Electronic control	Yes	
Standard programs stored	20	
Freely editable custom programs	Yes	
Phase parameters	Water type, detergent quantity, target temperature, time extension	
Tank internal temperature	From room-temperature to 95°C	
Accuracy	0,1°C	
Temperature sensors in tank	2 x PT 1000 CLASSI B IEC 60751	
Display	Multilingual graphic touch screen, color TFT type	
Detergent and neutralizing agent dosing system	Max. 4 peristaltic pumps, of which 2 as standard	
Detergent level sensor	Yes	
Detergent dosage control	Yes	
Safety lock	Yes, with security unlocking system	
Safety devices	Safety thermostats, door locks, interlocked doors, emergency door release, switch general safety power supply	
Alarm display	>100	
Troubleshooting menu	Yes	
Program editing	Yes	
Display languages	Italian, English, French, German, Russian, Spanish, Portuguese, Polish	
AUXILIARY FUNCTIONS		
Duct for introducing external probes	Yes	
Control system for drain separation solenoid valves	Yes, solenoid valves as optional	
USB port	Yes, for downloading wash cycles on a flash drive	
LAN port	Optional	
Printer	Integrated(optional)	
Cycles archiving	Yes	
Download archive cycles	Yes	
DRYING SYSTEM		
Drying fan	Yes - 2	
Drying heating element	7,2 kW	
Prefilter class C 98%	Yes, 2	
HEPA filter Class S 99.999%	Yes, 2	
WATER SUPPLY (PRESSURE 1-6 BAR)		
Cold water inlet	Yes	
Demineralized water inlet	Yes	
Demineralized water booster pump	Yes	
Water softener incorporated	Optional	
Incorporated softener	No	
Recirculation pump	1.200 l/min	
Drain	Floor drainage (possibility of wall drainage with optional pump)	
WATER HEATING		
Electrical	18kW	
Boiler water preheating	Optional, specific model available	
STEAM CONDENSER		Yes, optional
DIMENSIONS L X D X H MM		
Outside (with built-in top)	900 x 1000 x 1950	
Inside	626 x 812 x 685	
Net weight (Kg)	400	
STAINLESS STEEL		
Wash tank	AISI 316L	
Exterior covering	AISI 304	
ELECTRICAL POWER SUPPLY		
Max. voltage/power	400V 3N~ / 50Hz / 20 kW	
NOISE LEVEL		Max 66 dBA

ACCESSORIES

SURGICAL INSTRUMENTS BASKETS WITH RAILS

COMPATIBLE
WD2145
WD1160
WD4060
WD4190
WD5090T



D-CS1

UPPER LEVEL SURGICAL INSTRUMENT BASKETS

Basic upper basket with sprayer for the WD2145 series. Suitable for surgical instrument treatment.



D-CS2

LOWER LEVEL SURGICAL INSTRUMENT BASKETS

Basic lower basket with sprayer for the WD2145 series. Suitable for surgical instrument treatment.



CS1-1

UPPER LEVEL SURGICAL INSTRUMENT BASKETS

Basic upper basket with sprayer. Suitable for surgical instrument treatment.



CS2

LOWER LEVEL SURGICAL INSTRUMENT TROLLEY

Basic lower basket with sprayer. Suitable for surgical instrument treatment.

SURGICAL INSTRUMENT BASKETS WITHOUT RAILS

COMPATIBLE
WD1160
WD4060
WD4190
WD5090T



CSK4B

2-LEVEL SURGICAL INSTRUMENT LOAD CARRIER

Suitable for treating standard and large-sized surgical instruments. Two washing levels served by an incorporated sprayer and sprayer on the bottom of the machine. Minimum working height 165 mm. To be fitted with 4 CSK DIN baskets.



CSK4BMIC

2-LEVEL SURGICAL INSTRUMENT LOAD CARRIER

Suitable for treating standard and large-sized surgical instruments and, at the same time, minimally invasive surgery accessories. Two washing levels with an incorporated sprayer on the upper level and the lower level uses the sprayer situated at the bottom of the wash chamber. Connection at the KITMIC10 basket available on the upper level. Minimum working height 165 mm. To be used with 3 CSK DIN baskets and 1 KITMIC10 basket (instead of 4 DIN baskets) .



CSK6B

3-LEVEL SURGICAL INSTRUMENT LOAD CARRIER

Suitable for treating standard and large-sized surgical instruments. Three washing levels served by two incorporated sprayers and a sprayer on the bottom of the machine. Minimum working height 75 mm. To be fitted with 6 CSK DIN



CSK8B

4-LEVEL SURGICAL INSTRUMENT LOAD CARRIER

Suitable for treating standard and large-sized surgical instruments. Four washing levels served by three incorporated sprayers and a sprayer on the bottom of the machine. Minimum working height 64 mm. To be fitted with 8 CSK DIN baskets. CSK8B: The latter solution is particularly suitable for dealing with large quantities of instruments from different sources that need to be kept separate.

ACCESSORIES

INSTRUMENT WASHING TROLLEYS FOR MINIMALLY INVASIVE SURGERY

COMPATIBLE
WD1160
WD4060
WD4190
WD5090T



EF5

RIGID ENDOSCOPE AND VIDEO LAPAROSCOPE TROLLEY

Injection trolley for washing and drying rigid endoscopy and videolaparoscopy instruments. Special injectors and quick-connect connections inject the detergent and disinfectant solution into the internal channels of the instruments, while external washing is provided by the spray arm at the bottom of the tank. Direct connection to the hydraulic circuit via a self-adjusting quick coupling system.

EF5DS

TROLLEY EQUIPPED WITH DRYING SYSTEM CONNECTION

Trolley equipped with:

- No. 20 injection fittings for processing hollow bodies equipped with:
- No. 6 silicone connections with 1-mm hole
- No. 6 silicone connections with 6-mm hole
- No. 4 silicone connections with 10-mm hole
- No. 4 ULBEF2 fittings
- No. 20 luer lock connections on silicone tubes to connect the instruments
- No. CSK2



CPCENDO

ENDOSCOPE CONTAINER WASHING LOAD CARRIER

Load carrier for washing an endoscope container with cover size max. :
Cover LxPxH = 510x410x30 mm
Container LxPxH = 515x430x120 mm.
To be used with IRCP sky sprayer

SPECIAL LOAD CARRIER

COMPATIBLE
WD1160
WD4060
WD4190
WD5090T



AE2BDS

ANESTHESIA LOAD CARRIER

Trolley for treating anaesthesia instruments. It is equipped with an injection system for cleaning the inside of corrugated tubes with 10 nozzles (3 mm diameter) and 3 injectors (6 mm diameter). Direct connection to the hydraulic unit is made through a quick-coupling self-adjusting system.

Equipped with:

- 8 injection supports for corrugated tubes with a max. length of 150mm
- 13 nozzles for catheters
- 3 balloon nozzles
- 4 supports for masks and accessories



CM3

MASK WASHING LOAD CARRIER

Two-level trolley for washing and treating various types of masks. It holds up to 24 masks. Specifically, 8 masks can be placed on the top level and 16 on the bottom level. Uniform mask spraying is guaranteed by the sprayer on the bottom of the wash chamber and by the second sprayer arm placed between the 2 washing levels. Direct connection to the hydraulic unit is made through a quick-coupling self-adjusting system.



CPC1

CONTAINER LOAD CARRIER

Load carrier for washing 2 containers and 2 lids with max. dimensions of 300 x 300 x 150mm (LxDxH). Complete container cleaning is guaranteed by a sprayer arm on the bottom of the wash chamber and by the second one placed on the trolley. Direct connection to the hydraulic unit is made through a quick-coupling self-adjusting system.

ACCESSORIES

OPERATING ROOM SHOES TROLLEY



ZCS3B

WASHING TROLLEY FOR OPERATING ROOM SHOES

Two-layer washing trolley for the treatment of operating room shoes. Capacity 14 pairs of operating room shoes. In particular, it is possible to place 4 pairs of operating room shoes on the upper shelf and 10 pairs of shoes on the lower shelf. The special shape of the hooks supporting the shoes is designed to prevent possible deformation of the rubber due to the temperatures reached in the tank. Uniform spraying of shoes is ensured by the sprayer at the bottom of the tank and a second spraying arm positioned between the two washing layers. Direct connection to the hydraulic circuit via a self-adjusting quick coupling system. Made in stainless steel.



ZCS1

UPPER SURGICAL SHOE BASKET

Upper shoe basket with sprayer. It holds 4 pairs of shoes.

D-ZCS1

UPPER SURGICAL SHOE BASKET

Upper shoe basket with sprayer for WD2145 series. It holds 3 pairs of shoes.



ZCS2B

LOWER SURGICAL SHOE BASKET

Lower shoe trolley. It holds 10 pairs of shoes.

D-ZCS2

LOWER SURGICAL SHOE BASKET

Lower shoe basket for the WD2145 series. It holds 4 pairs of shoes.

BABY-BOTTLE WASHING ACCESSORIES



CS3

UNIVERSAL SUPPORT LOAD CARRIER

Two-level universal support load trolley with an incorporated sprayer and a sprayer on the bottom of the machine. Direct connection to the hydraulic unit is made through a quick-coupling self-adjusting system. It is suitable for positioning baby bottle baskets or for supports and various baskets. Made in stainless steel.



CONTAINER BIBERON

Container for 18 baby bottles with lids. Positioning on a standard CS3 load carrier. Space needed: half a rack for each level. Made in stainless steel.

CB18

for 250 ml baby bottles
Dimensions l x p x h 210 x 425 x 195 mm

CB18/120

for 120 ml baby bottles
Dimensions l x p x h 210 x 425 x 125 mm

CB18/100

for 100 ml baby bottles
Dimensions l x p x h 210 x 425 x 115 mm



CPS20

CONTAINER FOR 20 PACIFIERS

Metal-netted container with lid. Positioned on a standard CS3 load carrier. Two baskets can be overlapped to increase the surgical instrument load capacity. Made in stainless steel. Space needed: half a rack for each level. Dimensions: 430 x 190 x 60 mm (L x D x H). Mesh 5 x 5 mm.

ACCESSORIES

SURGICAL INSTRUMENT INSERTS

COMPATIBLE
WD1160
WD4060
WD4190
WD5090T



CSK1

1-LEVEL SURGICAL INSTRUMENT INSERTS

Suitable for large-sized surgical instruments (ex. abdominal retractors, self-retaining retractors, lateral valves, etc.).

Dimensions: L x D x H 450 x 450 x 55mm, mesh 5 x 5mm
Space needed: entire washer level



CSK2

HALF-LEVEL SURGICAL INSTRUMENT INSERTS

Suitable for medium-sized surgical instruments (ex. clamps, haemostatic forceps, scissors, suture instruments, etc.).

Dimensions: L x D x H 450 x 225 x 50mm, mesh 5 x 5mm
Space needed: half of a washer level



CSKDIN

HALF-LEVEL SURGICAL INSTRUMENT INSERTS

Suitable for medium-sized surgical instruments (ex. clamps, haemostatic forceps, scissors, suture instruments, etc.).

Dimensions: L x D x H 480 x 245 x 50mm, mesh 5 x 5mm
Space needed: half of a washer level



KITMIC10

CANNULATED INSTRUMENT INSERTS

Suitable for medium-sized minimally invasive surgery instruments. Suitable for CSK4BMIC only.

Dimensions: L x D x H 480 x 245 x 50mm, mesh 5 x 5mm
Space needed: half of a washer level



CSK1/3

1/3-LEVEL SURGICAL INSTRUMENT INSERTS

Suitable for medium-sized surgical instruments (ex. clamps, haemostatic forceps, scissors, suture instruments, etc.).

Dimensions: L x D x H 435 x 160 x 50mm, mesh 5 x 5mm
Space needed: one third of a washer level



CSK1/6

1/6-LEVEL SURGICAL INSTRUMENT INSERTS

Suitable for various small-sized surgical instruments (ex. scalpels, surgical scissors, small forceps, etc.).

Dimensions: L x D x H 130 x 225 x 50mm
Mesh: cover 5 x 5mm, basket 3 x 3 mm
Space needed: one sixth of a washer level

ACCESSORIES

SURGICAL INSTRUMENT INSERTS

COMPATIBLE
WD1160
WD4060
WD4190
WD5090T



D-SV

VERTICAL INSERT

Suitable for holding various surgical instruments in the vertical position (ex. Forceps, probes, swab holders, spatulas, osteotomies, chisels, etc.).
Divided into multiple compartments and a central inclined tub for washing water drainage.



D-CM1

Suitable for holding various surgical instruments
Mesh Insert: 3x3 mm
Made of stainless steel.
Dimensions: lxdxh 300x155x115 mm.



CSMICRO1

TINY SURGICAL INSTRUMENT INSERT

Surgical instrument basket with handles and lid.

Dimensions: L x D x H 240 x 235 x 55 mm, mesh insert 3 x 3 mm
Space needed: 1/4 of a washer level
Suitable for various tiny instruments or very small instruments in general.



CSMICRO2

TINY SURGICAL INSTRUMENT INSERT

Surgical instrument basket with handles and lid.

Dimensions: L x D x H 100 x 80 x 45 mm, mesh insert in micro-stretched netting.
Suitable for very small instruments in general.



CSMICRO3

TINY SURGICAL INSTRUMENT INSERT

Dimensions: L x D x H 280x168x45 mm, basket mesh in micro-stretched netting.



BFS

SUPPORT SPECULUM

Support for vertical positioning of speculum. Made in stainless steel.
Space needed: 1/4 washer level Suitable housing 6 speculum both single and dual



SA3

HOLDS 4 KIDNEY BOWLS

Space needed: half washer level of a CS3 load ca



SCVO

ASPIRATION TUBE SUPPORT AND COLD LIGHT CABLES

Suitable for the positioning of suction hoses and cold light cables.

Capacity: up to 2 cables / tubes
Space needed: 1/4 of a washing basket CS2



To achieve high quality wash standards, it is recommended to use properly treated water. To ensure maximum performance in the pre-washing, washing and neutralizing stages, always use softened water. All under counter models have an efficient integrated water softener that can reduce the hardness of the water supply, eliminating the formation of whitish spots inside the chamber and on the treated instruments.



WP3010
RESIN COLUMN WATER PURIFIER

The WP3010 water purifier is used to produce deionised water at 0.8-1 $\mu\text{S}/\text{cm}$, suitable for the final rinsing of instrument washers. The system uses mixed bed resins (disposable) which can also retain silica. When the resins run out, they can simply be replaced with the MI700WP kit. The resin cartridge is made out of stainless steel, as is the entire machine. Net capacity of cartridge: 15 litres. Dimensions: l x d x h = 300x600x850 mm.



MI700WP

Anion/cation mixed bed resins kit for the WP3000 water purifier. Total exchange capacity 42700 litres/°F* end of cycle at 5 $\mu\text{S}/\text{cm}$ (*Hardness in French degrees). Supplied with used resin disposal bag.

	WS11EB	WS14EB	WS17EB
MAXIMUM FLOW RATE	1800 l/h (43 l/min)	2000 l/h (43 l/min)	2200 l/h (43 l/min)
NOMINAL FLOW RATE	1500 l/h (43 l/min)	1600 l/h (43 l/min)	1800 l/h (43 l/min)
RESIN CAPACITY IN LITRES	11	14	17
EXCHANGE CAPACITY (m3/°F)	66	84	102
CYCLE CAPACITY AT 40°F	1650	2250	2700
PROGRAMMABLE RESIDUAL HARDNESS	0-10° F	0-10° F	0-10° F
REGENERATING AGENT TYPE	NaCl SALT	NaCl SALT	NaCl SALT
REGENERATING AGENT CONSUMPTION	1.0 kg/cycle	1.2 kg/cycle	1.8 kg/cycle
DIMENSIONS ØxH (mm)	300 x 470 x 660	300 x 470 x 815	300 x 470 x 1070
SALT TANK DIMENSIONS L x P x H (mm)	integrated	integrated	integrated
CAPACITY LITRES (SALT)	about 20	about 30	about 40
CONNECTIONS	1"	1"	1"



WS14E

WATER TREATMENT SYSTEMS

The WS series of appliances are technological water softeners capable of completely eliminating lime scale from water. The resins are regenerated using normal sodium chloride. Available in versions with flow rates of up to 2200 litres/hour, the models are fitted with an electronically controlled head which can be programmed depending on the hardness of the water. They provide backflow regeneration based on the volume of water (bearing in mind the resin saturation rate) and proportional brine in order to optimise water and salt consumption.

The use of specific detergents is essential to obtain accurate instrument washing. Smeg has a full range which are specially designed for instrumentation. Alkaline and enzymatic detergents should be used in the washing phase as well as neutralizing acids in the neutralization phase. Smeg also recommends a disinfectant dedicated to the treatment of thermoplastic instrumentation and anaesthesia tools to help the thermo-chemical process.

SANITISER ECOSEPT

Liquid disinfection additive based on phenoxyethanol. Ideal for use when washing operating room shoes in the washer disinfectant. 5 litres container

ph 5,5

ACID

1

2

3

4

5

6

7

8

9

10

11

12

13

14

LIQUID ACID NEUTRALISERS

ACIDGLASS C2

Weak organic acid neutralizer, phosphates free. Recommended for restoring the pH value in the tank after washing with a specific alkaline washer disinfectant. 5 litres container

ph 2,4

ALKALINE DETERGENTS

DETERLIQUID C2

Universal liquid alkaline detergent. Recommended for various types of dirt, especially blood, organic and bone residues. 5 litres container, phosphate-free.

ph 13,1

BASIC

MACHINE TECHNICAL FEATURES

	WD2145	WD1160	WD4060	WD4190
INTERNAL DIMENSIONS (LXWXH MM)	370x480x620	530x510x620	530x510x620	530x510x620
EXTERNAL DIMENSIONS (LXPXH MM)	450x620x850 (830 with built-in top)	600x600x850 (830 with built-in top)	600x600x850 (830 with built-in top)	900x600x850 (830 with built-in top)
TOTAL PROGRAMS	15	15	15	15
PRESET PROGRAMS	9	9	9	9
CUSTOM PROGRAMS	6	6	6	6
DETERGENT DOSING SYSTEM	peristaltic pump	peristaltic pump	peristaltic pump	peristaltic pump
NEUTRALISING DOSAGE SYSTEM	peristaltic pump	peristaltic pump	peristaltic pump	peristaltic pump
MAX NR. PERISTALTIC PUMPS	2	3	3	3
VOLUMETRIC DETERGENT CONTROL	n.a.	si	si	si
VOLUMETRIC DETERGENT CONTROL	n.a.	n.a.	n.a.	si
DISPLAY	with segments and warning light			
CONTROL PANEL	membrane keyboard			
PRINTER	optional - external	optional - external	optional - external	external or integrated
BOILER	n.a.	n.a.	n.a.	n.a.
DRYING SYSTEM	thermodynamic	thermodynamic	forced hot air through "drying system"	forced hot air through "drying system"
PRE-FILTER CLASS C	n.a.	n.a.	si	si
FILTRO HEPA CLASSE WITH 99.999%	n.a.	n.a.	si	si
COLD WATER SUPPLY	yes	yes	yes	yes
HOT WATER SUPPLY	no	no	no	no
DEMINERALIZED WATER SUPPLY	yes	yes	yes	yes
INTEGRATED SOFTENER	yes	yes	yes	yes
WASHING PUMP	200l/min	400l/min	400l/min	400l/min
CONDUCTIVITY CONTROL POSSIBILITY	n.a.	n.a.	n.a.	n.a.
DOOR INTERLOCK	yes	yes	yes	yes
NET WEIGHT (KG)	61	74	77	83
CONFORMITY	see declaration of conformity			
POWER SUPPLY/TOTAL POWER INSTALLED	1/N/PE/230V~/ 50Hz / 3,3kW	3/N/PE/400V~/ 50Hz / 7,0kW as an alternative: 1/N/PE/230V~/ 50Hz / 2,8kW	3/N/PE/400V~/ 50Hz / 7,0kW as an alternative: 1/N/PE/230V~/ 50Hz / 2,8kW	3/N/PE/400V~/ 50Hz / 7,0kW as an alternative: 1/N/PE/230V~/ 50Hz / 2,8kW
POSSIBILITY OF 60HZ SUPPLY	yes	yes	yes	yes
EQUIPPED WITH PLUG	yes	no	no	no

	WD5090T	WD6010	WD7010	WD7015
INTERNAL DIMENSIONS (LXWXH MM)	530x510x620	550 x 620 x 685	550 x 620 x 685	626 x 812 x 685
EXTERNAL DIMENSIONS (LXPXH MM)	900x640x850 (830 with built-in top)	650 x 720 x 1950	780 x 800 x 1950	900 x 1000 x 1950
TOTAL PROGRAMS	30	40	40	40
PRESET PROGRAMS	20	20	20	20
CUSTOM PROGRAMS	10	20	20	20
DETERGENT DOSING SYSTEM	peristaltic pump	peristaltic pump	peristaltic pump	peristaltic pump
NEUTRALISING DOSAGE SYSTEM	peristaltic pump	peristaltic pump	peristaltic pump	peristaltic pump
MAX NR. PERISTALTIC PUMPS	5	4	4	5
VOLUMETRIC DETERGENT CONTROL	optional	yes	yes	yes
VOLUMETRIC DETERGENT CONTROL	yes	yes	yes	yes
DISPLAY	backlit graphic LCD display 128x64 pixel	TFT colored	TFT colored	TFT colored
CONTROL PANEL	membrane keyboard	touch	touch	touch
PRINTER	external or integrated	optional	optional	optional
BOILER	optional	optional - available a specific model	optional - available a specific model	optional - available a specific model
DRYING SYSTEM	forced hot air through "drying system"	Forced hot air	Forced hot air	2 motors for hot air through "drying system"
PRE-FILTER CLASS C	yes	yes	yes	yes
FILTRO HEPA CLASSE WITH 99.999%	yes	yes	yes	yes
COLD WATER SUPPLY	yes	yes	yes	yes
HOT WATER SUPPLY	yes	yes	yes	yes
DEMINERALIZED WATER SUPPLY	yes	yes	yes	yes
INTEGRATED SOFTENER	yes	no	no	no
WASHING PUMP	400l/min	600l/min	600l/min	1.200l/min
CONDUCTIVITY CONTROL POSSIBILITY	optional	optional	optional	optional
DOOR INTERLOCK	yes	yes	yes	yes
NET WEIGHT (KG)	83	280	300	400
CONFORMITY	see declaration of conformity			
POWER SUPPLY/TOTAL POWER INSTALLED	1/N/PE/230V- 50Hz- 2,8kW as an alternative: 3/N/PE/400V- 50Hz- 7,0kW	400V 3N~ / 50Hz /400V 3N~ / 50Hz / 13 kW	400V 3N~ / 50Hz /400V 3N~ / 50Hz / 13 kW	400V 3N~ / 50Hz / 20 kW
POSSIBILITY OF 60HZ SUPPLY	yes	yes	yes	yes
EQUIPPED WITH PLUG	no	no	no	no



Smeg S.p.A.
via Leonardo da Vinci, 4 - 42016 Guastalla (RE) - Italy
E-mail: instruments@smeg.it - www.smeg-instruments.com